



# UTILITY PUMP INSTALLATION INSTRUCTIONS

	<p><b>WARNING</b> Explosions hazard. DO NOT PUMP FLAMMABLE LIQUIDS WITH THIS UNIT.</p>
	<p>Never operate the pump in an explosive environment. Arcing from the motor brushes, switch or excessive heat from an improperly cycle motor may cause an explosion.</p>

## FEATURES:

**Suitable for Pumping:** Engine oil, transmission fluids, anti-freeze solutions and low viscosity gear lubes

**Dry Run Capabilities:** Yes

**Pump Body:** Polypropylene

**Diaphragm:** Geolast, oil resistant

**Valves:** Buna-n

**Motor:** 12V DC with internal thermal protector

**Battery Leads:** 8 feet [ 2.4m ] with alligator clips (Premium Only)

**Duty Cycle:** Intermittent Duty

**Open Flow:** 1.5 GPM [5.8 L]

**Current Draw:** 4.5 Amps Max.

**Ports:** 3/8" Female NPT

**Control:** Internal By-Pass 35 PSI

## MOUNTING:

- Consider a location that allows for easy access if maintenance is required. The pump should not be located in an area less than one cubic foot unless adequate ventilation is provided. Excessive heat may trigger the integral thermal breaker and interrupt operation. When the motor temperature drops, the breaker will automatically reset and the pump will start.
- The pump may be mounted in any position. If mounted the vertically pump head should be in the down position so that in the unlikely event of a leak, fluid will not enter the motor.
- The pump can be positioned above the liquid tank if needed, as it is capable of 6ft [1.82M] vertical prime (with water).
- Use #8 hardware to fasten the pump. Choose a solid surface that will not amplify pump operation. The mounting feet are intended to isolate the pump from the mounting surface; over-tightening, flatterring, or use of oversized screws will reduce the ability to isolate noise and vibration.

## PLUMBING:

- SHURflo recommends 3/8" [9.5mm] or 1/2" [13mm] I.D. flexible high pressure tubing to both ports. Ideally, the pump ports/strainer should not be connected directly to rigid pipe. The pump's normal oscillation may trasmit through rigid plumbing causing noise, and possibly loosening or cracking components.
- Installation of a SHURflo 255 series strainer on the inlet side is recommended to prevent foreign debris from entering the pump. Failure due to debris is not covered under the SHURflo limited warranty.

## ELECTRICAL:

- The pump should be on a dedicated (individual) circuit, protected by the fuse indicated on the motor label.
- An "ON/OFF" switch rated at or above 15 amps is recommended. The switch must interrupt current flow on the positive (+ red) lead. Marine applications should use U/L approved marine duty (ignition protected) switches and wiring standards.
- The black lead (-) must be connected to a "known ground". The ground wire must be the same size (gauge/Mm<sup>2</sup>) as the positive wire.
- Wire size (gauge/Mm<sup>2</sup>) is based on the distance from the power source to the pump. The minimum recommended is # 14 gauge [2.5 Mm<sup>2</sup>]. Lenghts of 20-50 ft. [6-15M] use # 12 gauge [4 Mm<sup>2</sup>].
- The total current draw on the circuit must not exceed 15 amps. If the pump is used in conjunction with other components, overload current protection (fuse or circuit breaker) and wire size must be for the total amp requirement of all devices on the circuit.

**PREMIUM PUMPS:**

**WARNING** Explosions hazard. Motor switch **MUST** be in "OFF" position when connecting and disconnecting alligator clips to battery terminals and ground. The switch in an "ON" position can cause an electrical spark which can result in explosion. Injury or death can occur.

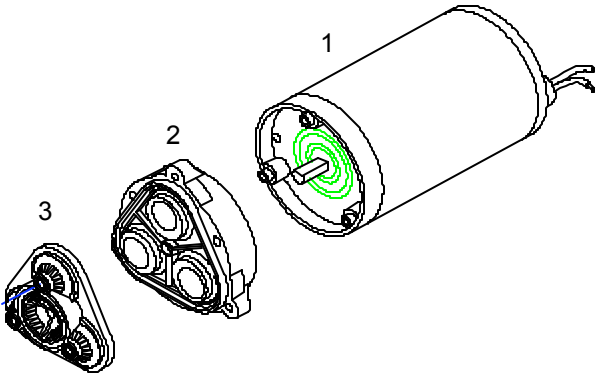
**PART KITS AVAILABLE:**

Number	Components	Parts Kits
1	Motor	11-148-06
2	Drive Assembly	94-385-42
8	Valve Assembly	94-390-27

Use adapter fitting when connecting a 255 strainer (included)

**STRAINERS AVAILABLE:**

Number	Components	Part Number
1	1/2" NPT-F x 1/2" BARB	255-113
2	1/2" NPT-M x 1/2" NPT-F	255-213
3	3/8" NPT-M x 1/2" NPT-M	8-145

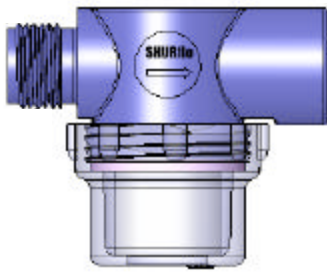
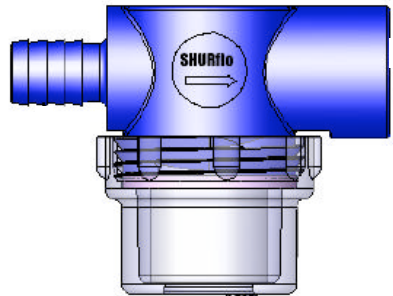
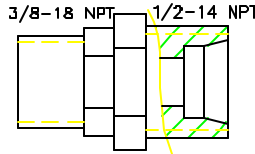

**LIMITED WARRANTY**

SHURflo warrants Diaphragm Pumps to be free from material and workmanship defects under normal use and service for a period of one (1) year from the date of manufacture or one (1) year of use with proof of purchase, not to exceed (2) years in any event. The limited warranty will not apply to pumps that were run dry, misapplied, or are incompatible with components not manufactured by SHURflo. Pump failure due to debris or chemical incompatibility is not covered under the terms of this limited warranty. SHURflo will not warrant any pump that is physically damaged, or altered outside the SHURflo factory. Warranty claims may be resolved by an authorized dealer service center, or by SHURflo. For complete warranty details, please call your closest SHURflo office.



★ ISO Certified Facility SHURflo reserves the right to update specifications, prices, or make substitutions.

**SHURflo \***  
 5900 Katella Ave.  
 Cypress, CA 90630  
 (562) 795-5200 (800) 854-3218  
 FAX (562) 795-7564  
**Shipping:** 5900C Katella Ave.  
 Cypress, CA 90630

**SHURflo East**  
 52748 Park Six Court  
 Elkhart, IN 46514-5427  
 (574) 262-0478 (800) 762-8094  
 FAX (574) 264-2169  
<http://www.shurflo.com>  
 © 2002 All Rights Reserved

**SHURflo Ltd. \***  
 Unit 5 Sterling Park  
 Gatwick Road, Crawley  
 West Sussex, RH10 2QT  
 United Kingdom  
 +44 1293 424000  
 FAX +44 1293 421880